

Prices

Holiday-prices 2008 with gourmet half-board		Nostalgia Single room Nostalgia Double room	Jugendstil Double room	Jugendstil Single room Liberty Double room	Ortler-Suite Attic- Suite Schlern	Garten Double room	Rosengarten- Suite Familien-Garten Latemar Apt.
SEASON A 19.4. – 10.5. 24.5. – 28.6. 5.12. – 21.12.	1-3 days person /day	€ 100,-	€ 110,-	€ 115,-	€ 120,-	€ 125,-	€ 130,-
	4-6 days person /day	€ 90,-	€ 100,-	€ 105,-	€ 110,-	€ 115,-	€ 120,-
	Weekly all-inclusive prices	€ 595,-	€ 665,-	€ 700,-	€ 735,-	€ 770,-	€ 805,-
SEASON B 10.5. – 24.5. 28.6. – 12.7. 6.9. – 9.11.	1-3 days person /day	€ 115,-	€ 125,-	€ 130,-	€ 135,-	€ 140,-	€ 145,-
	4-6 days person /day	€ 105,-	€ 115,-	€ 120,-	€ 125,-	€ 130,-	€ 135,-
	Weekly all-inclusive prices	€ 700,-	€ 770,-	€ 805,-	€ 840,-	€ 875,-	€ 910,-
SEASON C 12.7. – 26.7. 23.8. - 6.9.	1-3 days person /day	€ 130,-	€ 140,-	€ 145,-	€ 150,-	€ 155,-	€ 160,-
	4-6 days person /day	€ 120,-	€ 130,-	€ 135,-	€ 140,-	€ 145,-	€ 150,-
	Weekly all-inclusive prices	€ 805,-	€ 875,-	€ 910,-	€ 945,-	€ 980,-	€ 1015,-
SEASON D 26.7. – 23.8. 25.12. – 6.1.2009	1-3 days person /day	€ 145,-	€ 155,-	€ 160,-	€ 165,-	€ 170,-	€ 175,-
	4-6 days person /day	€ 135,-	€ 145,-	€ 150,-	€ 155,-	€ 160,-	€ 165,-
	Weekly all-inclusive prices	€ 910,-	€ 980,-	€ 1015,-	€ 1050,-	€ 1085,-	€ 1120,-

The above half-board prices include the following: Holzner's sumptuous breakfast buffet, 4 to 5 course menu in the evenings, gala dinners, hot and cold buffets, barbeque parties in the park, theme evenings, use of the new wellness area with pools (400 m²), bath robe and slippers, use of the park (10.000 m²) with herb gardens and flower gardens, sunbathing area, use of the two red-clay tennis courts (from May to October), use of the boccia (bowling) lane (May to October), reading halls with newspapers and library, selection of trekking and hiking guides at the reception, shuttle service from and to the central train station of Bozen (at prearranged times).

Room amenities

All rooms with bath or shower, colour TV and SAT, safe and direct call telephone. All suites and apartments comprise bedrooms, living rooms with extendable double settee or bunk bed, bath or shower, colour TV and SAT, safe and direct call telephone. In every room and apartment you will find a hairdryer, bath robe and slippers for every resident.



Nostalgia single room
North-facing ca. 18 m²

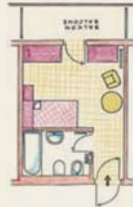

Jugendstil single room
South-facing with balcony
ca. 20 m²



Nostalgia double room
North-facing with balcony
ca. 28 m²



Jugendstil double room
South-facing with balcony
ca. 30 m²



Liberty double room
South-facing with porch
and terrace ca. 28 m²



Garten double room
2-4 person
South-facing onto the
park with garden terrace
ca. 40 m²



Ortlert Suite
2-4 person
North-facing ca. 39 m²



Schlern Attic-Suite
1x 40 m² for up to 4 pers.
1x 50 m² for up to 5 pers.
South-facing, both with
2 small balconies



Rosengarten-Suite
2-4 person
South-facing with balcony
ca. 40 m²



Familien-Garten
Latemar Apartment
South-facing onto the park
with porch and private
garden ca. 45 m².
Sep.children's room